

State Road (SR) 70/Okeechobee Road Resurfacing Project

SR 70/Okeechobee Road from Ideal Holding Road
to west of SR 713/Kings Highway

City of Fort Pierce, St. Lucie County

Financial Project ID: 447651-1-52-01

Meet the Team



Michael Jacobs

Construction Project Manager
FDOT District Four, Treasure Coast
Operations



Jeffrey Robbert, P.E.

Design Project Manager
FDOT District Four



Kevin Micocci, P.E.

Senior Project Engineer
Creative Engineering Group, Inc.



Cecilia Villoria, P.E.

Engineer of Record
CHA Consulting, Inc.



Ken Kroll

Project Administrator
Creative Engineering Group, Inc.



Rick Sheperd

Contractor
Halley Engineering
Contractors, Inc.

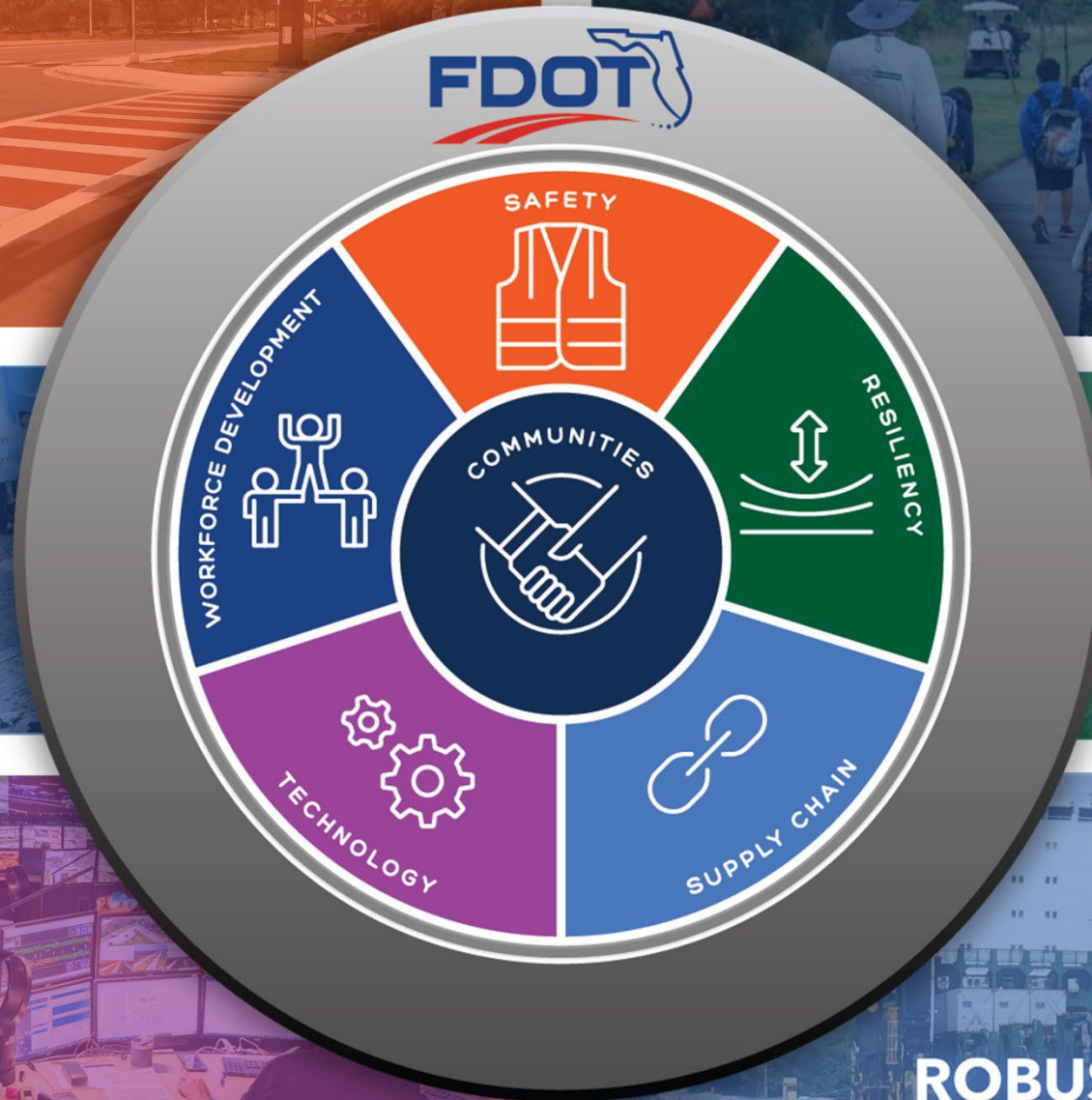

The Florida Department of Transportation is required to comply with various non-discrimination laws and regulations, including **Title VI of the Civil Rights Act of 1964.**

Public participation is solicited without regard to race, color, national origin, age, sex, religion, disability, or family status.

Persons wishing to express concerns about Title VI may do so by contacting either:

District Four

Florida Department of Transportation
District Four Title VI Coordinator

Sharon Singh Hagyan



(954) 777-4190,

Sharon.SinghHagyan@dot.state.fl.us

Tallahassee Office

Florida Department of Transportation
Statewide Title VI Coordinator

Stefan Kulakowski



(850) 414-4742,

Stefan.Kulakowski@dot.state.fl.us

All inquiries or concerns will be handled according to FDOT procedure and in a prompt and courteous manner.

2055 Florida Transportation Plan



SINGLE, OVERARCHING **PLAN**



GUIDES FLORIDA'S TRANSPORTATION **FUTURE**



FOUNDATION FOR FLORIDA'S WORK PROGRAM



UPDATED EVERY **5 YEARS**



COLLABORATIVE EFFORT WITH **PUBLIC AND PRIVATE PARTNERS**

Upcoming **Regional Workshops, Focus Group Meetings, Virtual Statewide Webinars**, and more!

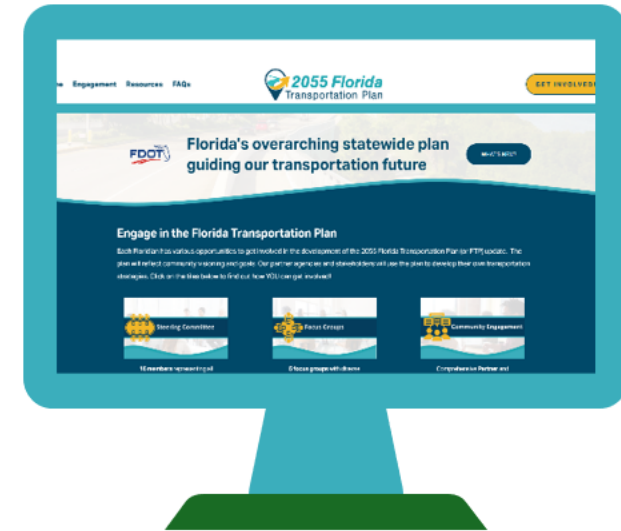

**Scan to
learn more!**



Get Engaged Today!

FloridaFTP.com

Project Limits

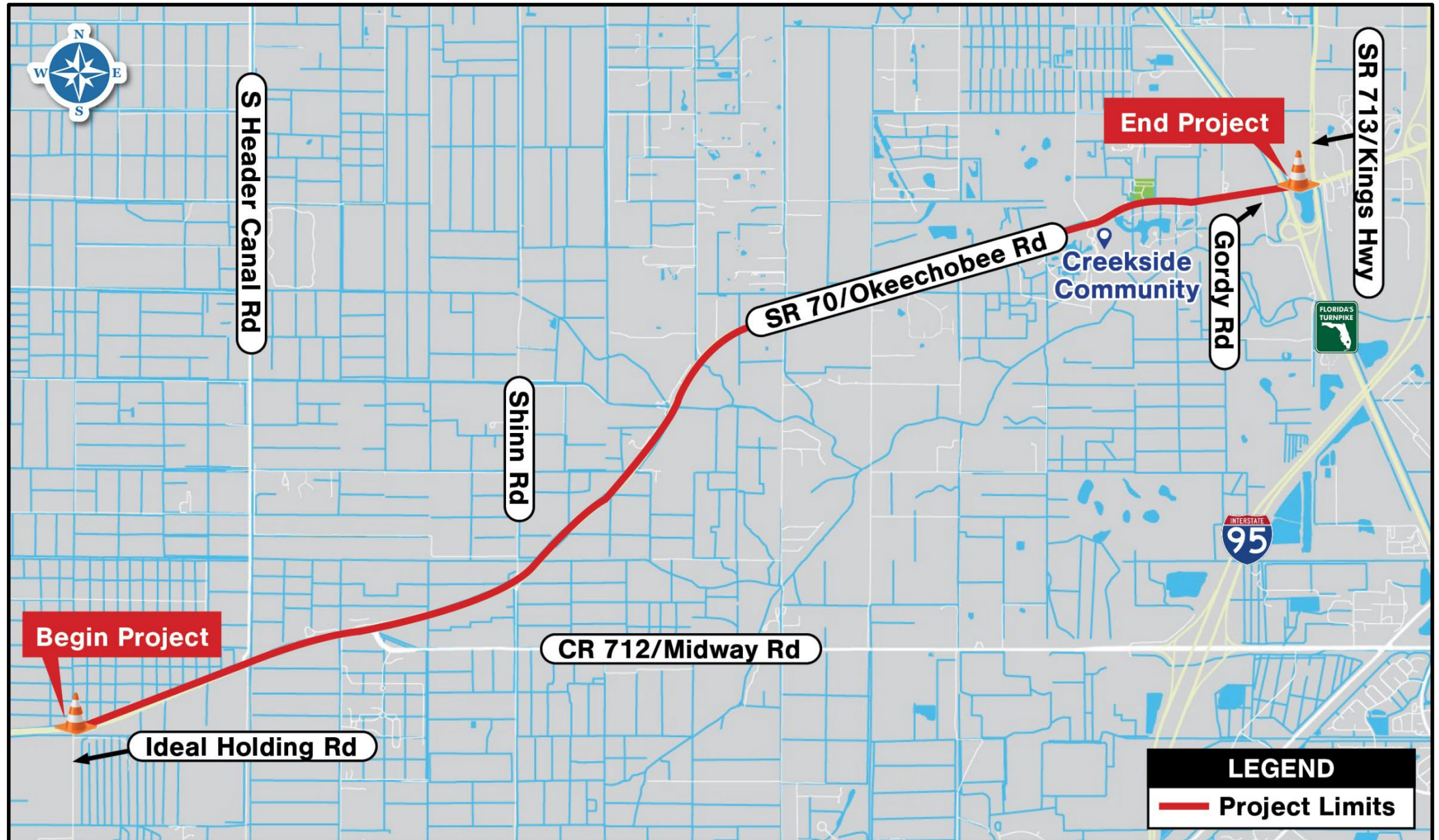

Project Overview

Purpose: This project aims to extend the pavement's service life through milling and resurfacing while enhancing roadway safety along the SR 70/Okeechobee Road corridor for motorists, bicyclists, and pedestrians.

Length: 7.984 miles

Contractor: Halley Engineering Contractors, Inc.

Construction Start: March 2025

Contract Cost: \$16.9 Million

Estimated Completion: Spring 2027



Existing shared-use path along
westbound SR 70/Okeechobee Road
west of SR 713/Kings Highway
(pre-construction)

Scope of Work

Roadway Improvements

Roadway Improvements

- Milling and resurfacing the existing roadway within the project limits to enhance safety and long-term resiliency
- Constructing new acceleration lanes on SR 70/Okeechobee Road at select locations to accommodate safe U-Turn movements
- Widening median left turn lanes on SR 70/Okeechobee Road at South Header Canal Road and Shinn Road for improved traffic operations
- Installing illuminated stop signs at Ideal Holding Road and South Header Canal Road to increase visibility and safety

Scope of Work

Roadway Improvements

Roadway Improvements

- Converting the intersections of South Header Canal Road and Shinn Road to Restricted Crossing U-Turn (RCUT) Intersections to improve traffic flow and safety by eliminating direct left turns and through traffic movements from side streets
- Installing rumble strips to enhance safety
- Extending lighting from east of CR 712/Midway Road to east of Shinn Road to boost nighttime visibility
- Upgrading signage and pavement markings to improve safety, functionality, and traffic operations

Scope of Work

Drainage and Pedestrian Improvements

Drainage Improvements

- Replacing drainage at various locations throughout the project limits to enhance functionality and long-term resiliency

Pedestrian Improvements

- Reconstructing existing sidewalk curb ramps throughout the project limits and installing a new 6-foot concrete sidewalk from the Creekside Community to the SR 91/Florida's Turnpike entrance at SR 713/Kings Highway to enhance safety and connectivity for pedestrians

Typical Section - SR 70/Okeechobee Road from Ideal Holding Road to the Creekside Community

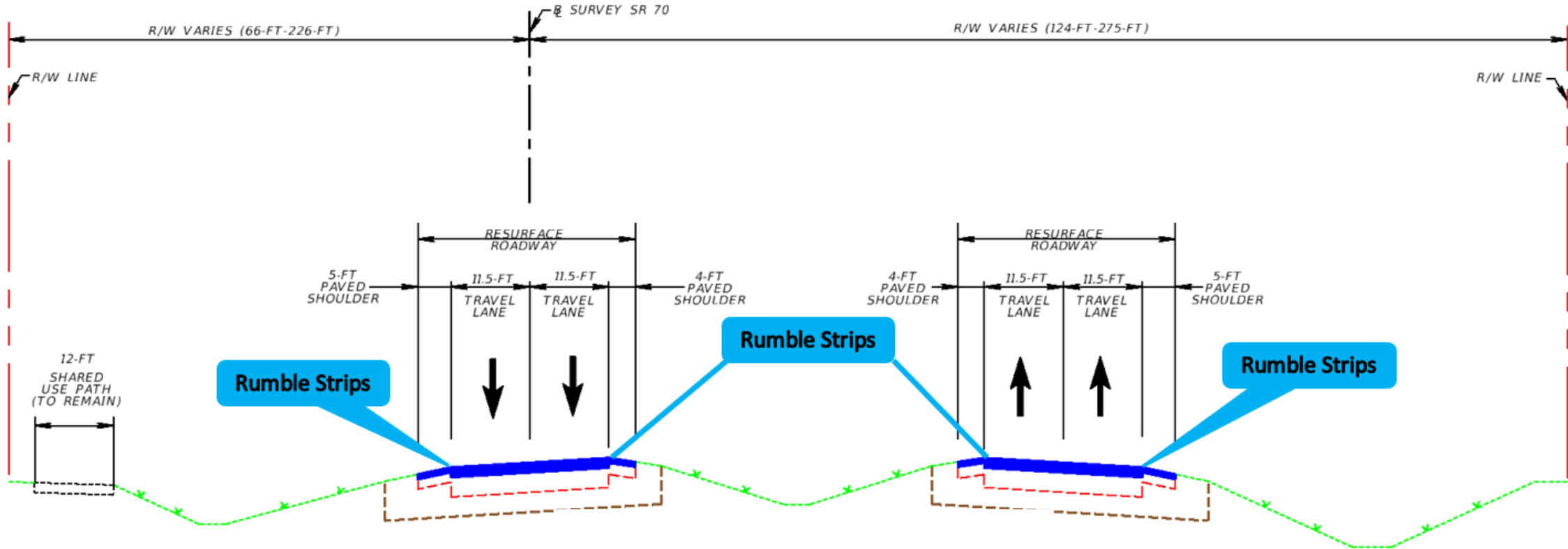

Typical Section – SR 70/Okeechobee Road from the Creekside Community to Gordy Road

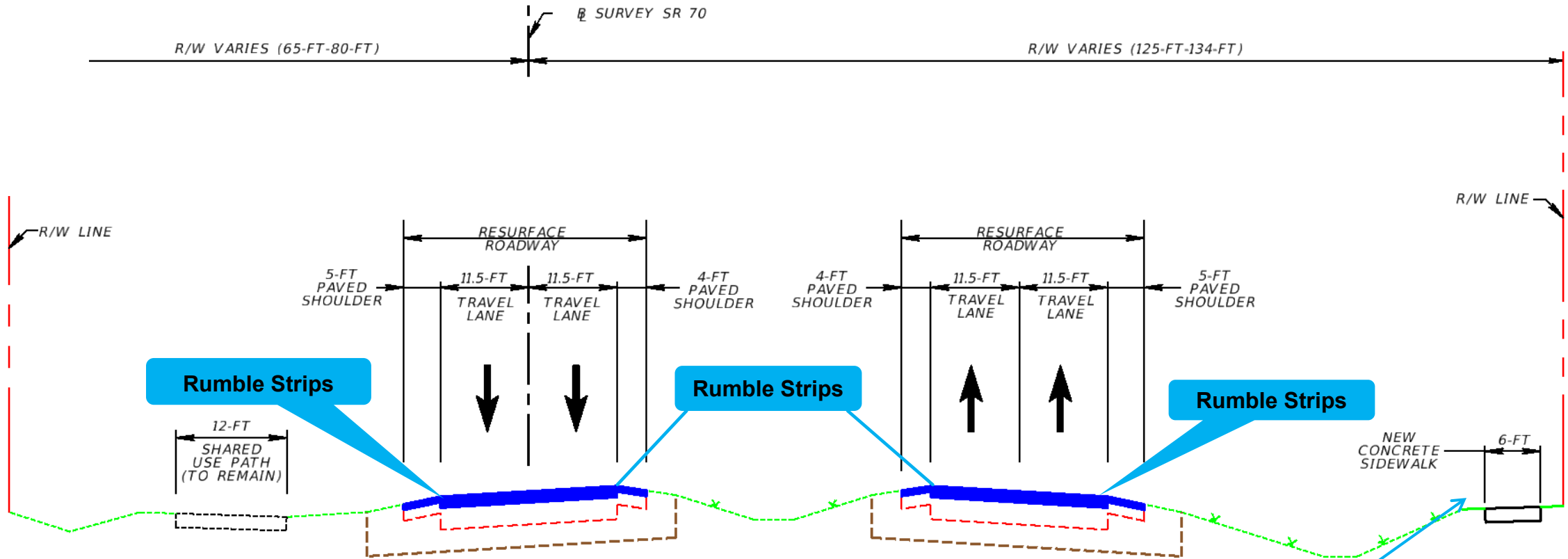

New sidewalk will be constructed from the Creekside Community to the SR 91/Florida's Turnpike.

Typical Section – SR 70/Okeechobee Road from Gordy Road to SR 713/Kings Highway

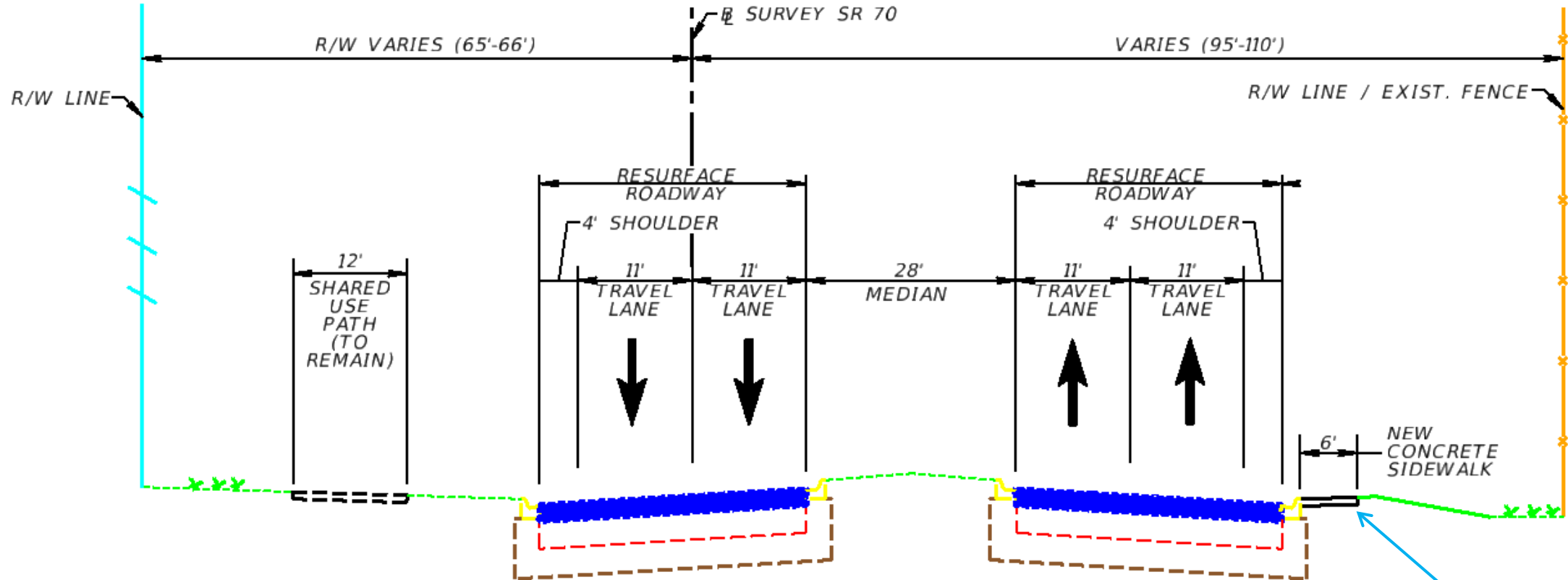

New sidewalk will be constructed along the back of the existing curb and gutter

Safety Improvements

SR 70/Okeechobee Road at South Header Canal Road

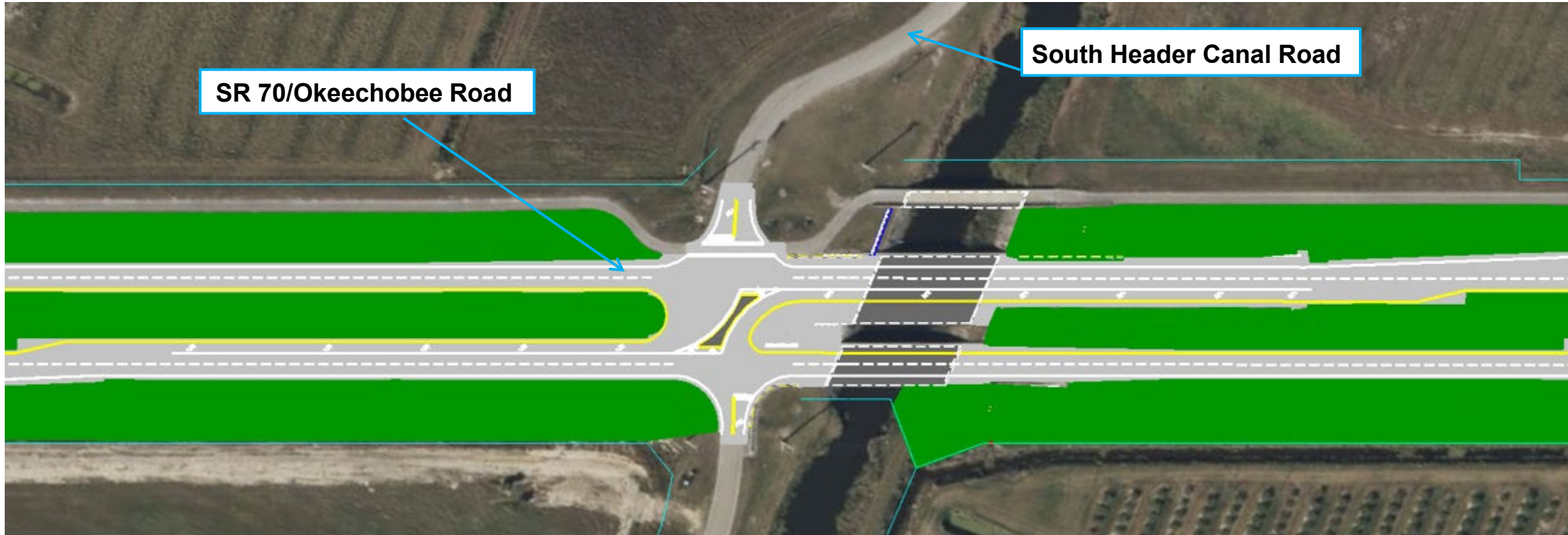

Safety Improvements

SR 70/Okeechobee Road at South Header Canal Road

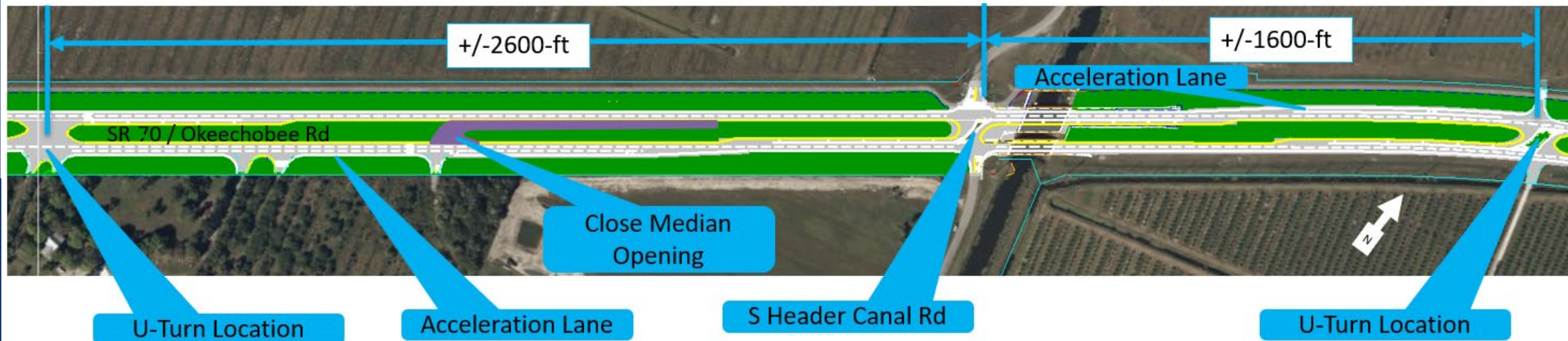

New Restricted Crossing U-Turn (RCUT) Intersection at South Header Canal Road:

- Eliminates the northbound South Header Canal Road to westbound SR 70/Okeechobee Road movement
- Eliminates the southbound South Header Canal Road to eastbound SR70/Okeechobee Road movement
- Closes the northbound and southbound movement from South Header Canal Road across SR 70/Okeechobee Road

Safety Improvements

SR 70/Okeechobee Road at South Header Canal Road

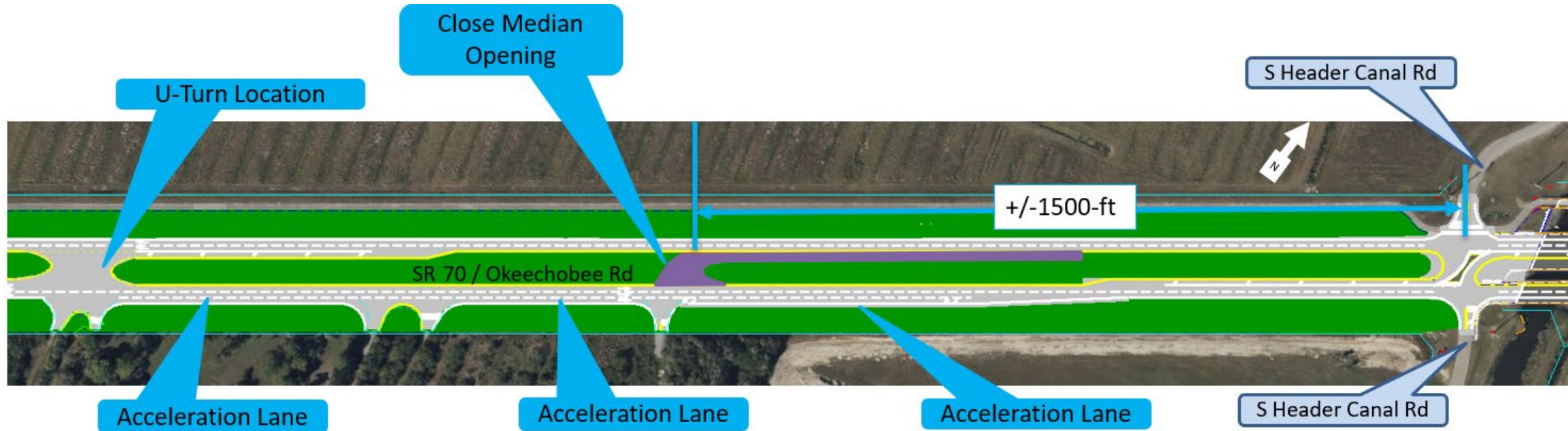

Safety Improvements:

- The existing median opening will be closed west of South Header Canal Road
- Southbound South Header Canal Road motorists will use the U-Turn location further west to access South Header Canal Road
- We are constructing new acceleration lanes on eastbound SR 70/Okeechobee Road to accommodate safe U-Turn movements

Safety Improvements

SR 70/Okeechobee Road at Shinn Road



Safety Improvements

SR 70/Okeechobee Road at Shinn Road



New Restricted Crossing U-Turn (RCUT) Intersection at Shinn Road:

- Eliminates the northbound Shinn Road to westbound SR 70/Okeechobee Road movement
- Eliminates the southbound Shinn Road to eastbound SR 70/Okeechobee Road movement
- Closes the northbound and southbound movement from Shinn Road across SR 70/Okeechobee Road

Lighting Improvements

SR 70/Okeechobee Road from east of CR 712/Midway Road to east of Shinn Road

PROPOSED
LOCATIONS FOR NEW LIGHTING
(not to scale)



Sidewalk Improvements

SR 70/Okeechobee Road from the Creekside Community to SR 713/Kings Highway



Constructing a new 6-foot sidewalk from the Creekside Community to the SR 91/Florida's Turnpike entrance at SR 713/Kings Highway to enhance safety and connectivity for pedestrians.

Maintenance of Traffic:

- Business, pedestrian, and residential access will be maintained at all times throughout construction
- Single-lane closures on SR 70/Okeechobee Road are permitted as follows:
 - Between Ideal Holding Road and Gordy Road daily and nightly, as needed
 - Between Gordy Road and SR 713/Kings Highway daily, from 9:00 a.m. to 4:00 p.m., Monday through Friday, and nightly, from 6:00 p.m. to 7:00 a.m., Sunday through Thursday

Maintenance of Traffic:

- In early 2026 (Phase 4 of construction), the median turn lanes on SR 70/Okeechobee Road to enter South Header Canal Road and Shinn Road will be closed to motorists; advanced notice will be provided



The SR 70/Okeechobee Road and Shinn Road intersection
looking west
(pre-construction)

South Header Canal Road Detour Routes

During Phase 4 of construction, the median and left-turn lanes on SR 70/Okeechobee Road at South Header Canal Road will be closed to traffic.

Southbound South Header Canal Road Detour

Go west on SR 70/Okeechobee Road to the median opening (+/-1500-feet west), make a U-Turn onto eastbound SR 70/Okeechobee Road to South Header Canal Road

Northbound SR 70/Okeechobee Road to South Header Canal Road Detour

Go east on SR 70/Okeechobee Road to the median opening (+/-1500-feet east), make a U-Turn onto westbound SR 70/Okeechobee Road to South Header Canal Road

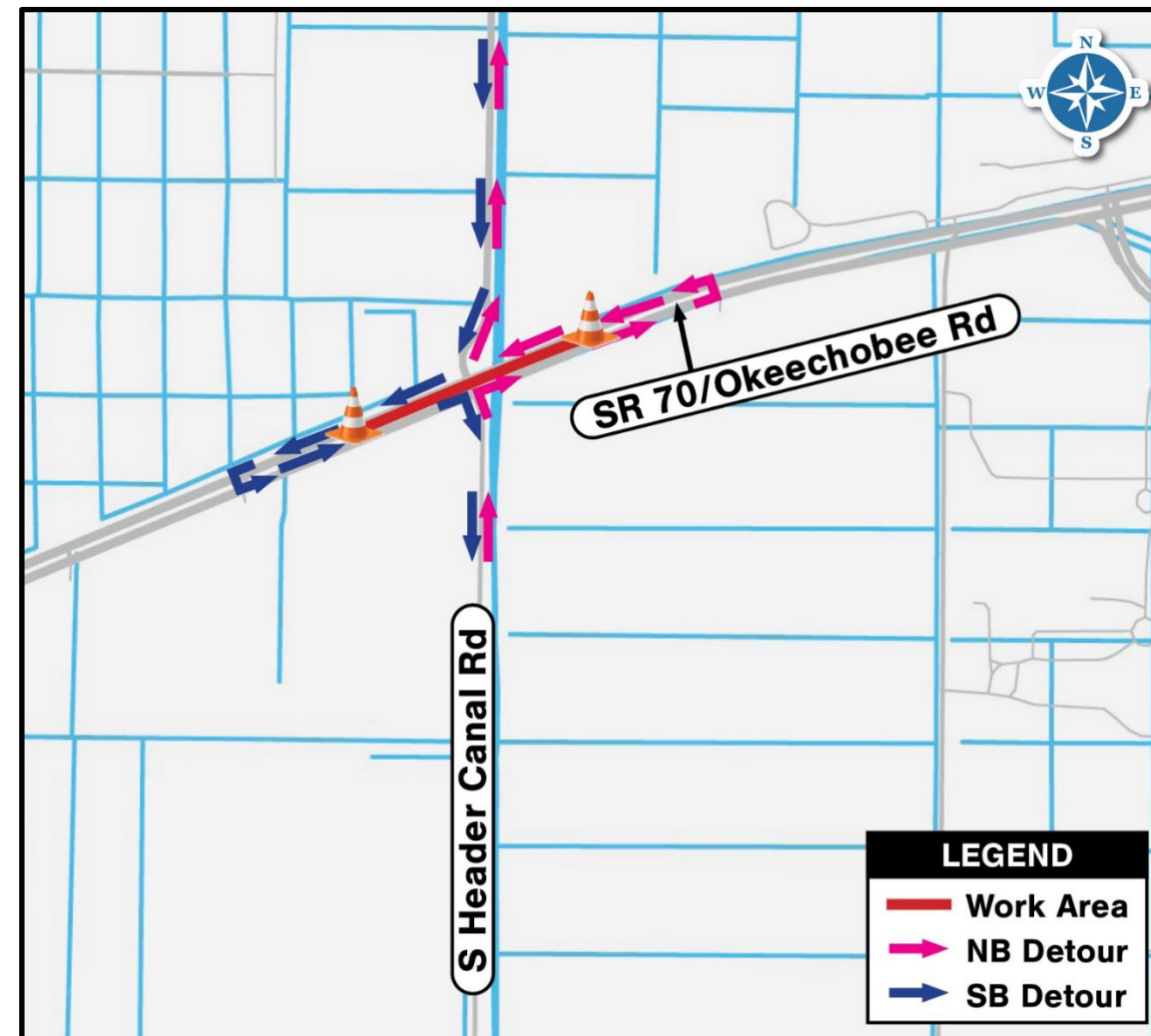

Shinn Road Detour Routes

During Phase 4 of construction, the median and left-turn lanes on SR 70/Okeechobee Road at Shinn Road will be closed to traffic.

Southbound Shinn Road Detour

Go west on SR 70/Okeechobee Road to the median opening, make a U-Turn onto eastbound SR 70/Okeechobee Road to Shinn Road

Northbound Shinn Road Detour

Go east on SR 70/Okeechobee Road to the median opening, make a U-Turn onto westbound SR 70/Okeechobee Road to Shinn Road

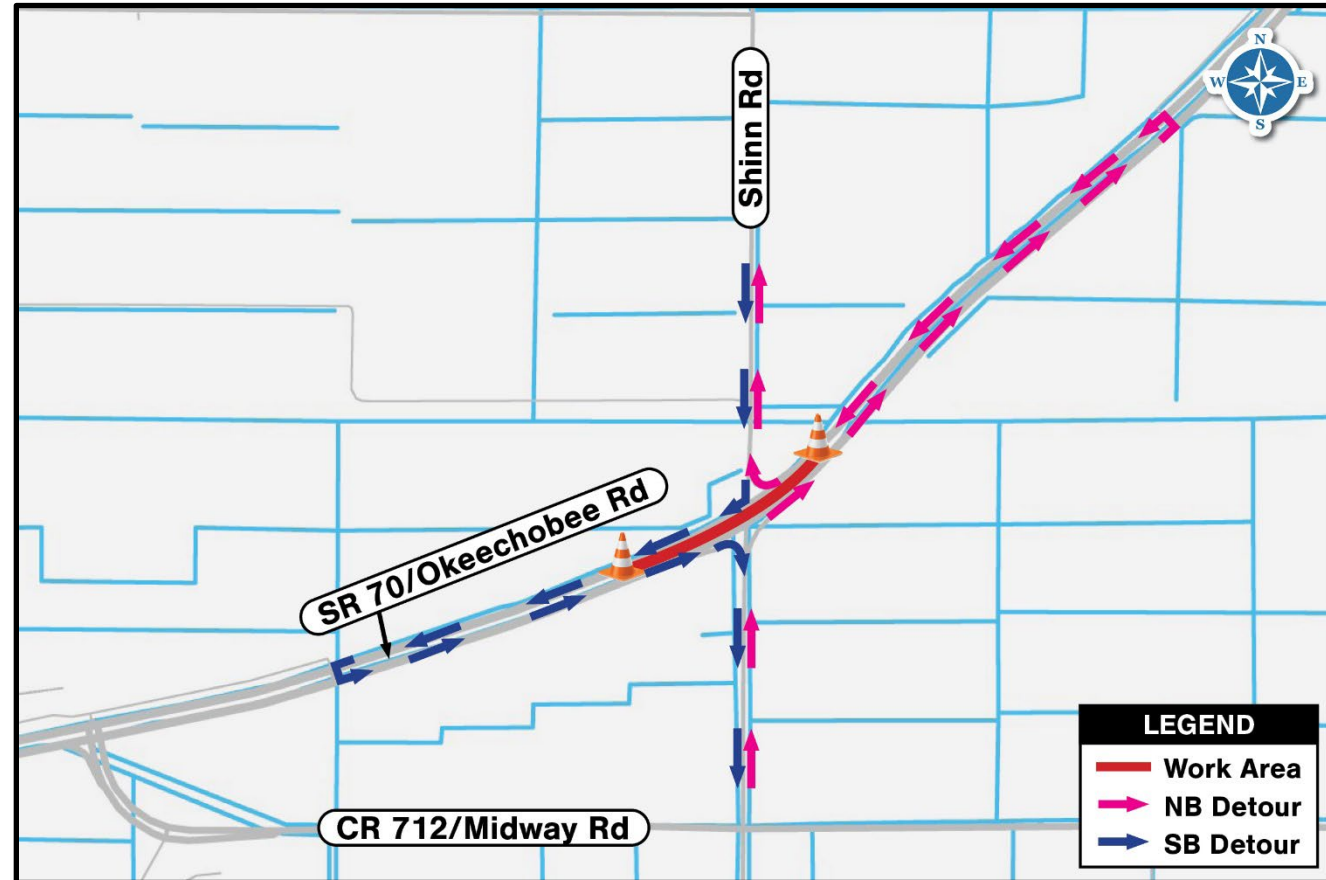

Construction Phases

Phase 1:

- Mill and resurface the SR 70/Okeechobee Road median crossovers with friction course asphalt
- Install temporary pavement markings and new sign panels



SR 70/Okeechobee Road at CR 712/Midway Road looking east
(pre-construction)

Construction Phases

Phase 2:

- Complete the inside travel lane widening at various locations throughout the project limits
- Construct the inside paved and unpaved shoulder and guardrail
- Perform clearing and grubbing
- Mill and resurface the inside travel lanes
- Install temporary pavement markings



SR 70/Okeechobee Road at Ideal Holding Road
looking east
(pre-construction)

Phase 3:

- Complete the outside travel lane widening at various locations throughout the project limits
- Construct the outside paved and unpaved shoulder and guardrail
- Perform clearing and grubbing and re-grade the swale
- Install sidewalk and curb and gutter
- Perform drainage improvements at various locations throughout the project limits
- Mill and resurface the outside travel lanes on SR 70/Okeechobee Road
- Install temporary pavement markings

Construction Phases

Phase 4:

- Convert the intersections of South Header Canal Road and Shinn Road to Restricted Crossing U-Turn (RCUT) Intersections
- Re-grade the swales
- Install temporary pavement markings



SR 70/Okeechobee Road at South Header Canal Road looking southeast
(pre-construction)

Phase 4:

- Place friction course throughout the project limits
- Install Traffic Monitoring Site (TMS) Inductive Loops east of Shinn Road
- Place rumble strips throughout the project limits



SR 70/Okeechobee Road looking west
(pre-construction)

Safety and Local Coordination

- **Public Safety is our Top Priority!**
 - **Work Zone Signage & Maintenance of Traffic**
 - Advanced warning and project signage will be placed throughout the construction corridor to alert the traveling public
 - **Local Agency & Stakeholder Coordination**
 - The project team will continue working closely with local stakeholders including local municipalities, schools, neighborhoods and other local agencies to ensure safety standards are met and impacts to the public are minimized in any way possible
 - **Emergency vehicles will be provided access at all times**

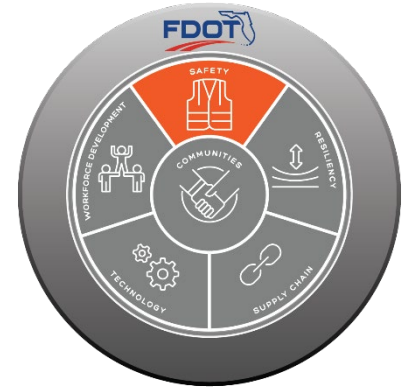

Lighted Message Board

Community Outreach

- To receive project specific updates please email skayser@corradino.com to be added to the distribution list
- A weekly press release will be distributed every Friday
- Additional project specific information can be found on the website

****All project updates will be posted to the District Four website.****



***Scan this QR code to go to the
District Four Website.***

www.d4fdot.com

Contact Us

Throughout the project, questions or comments can be submitted via email or phone.

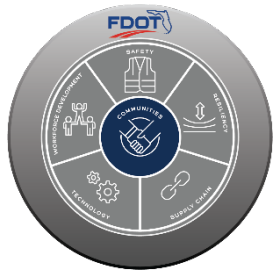

Samantha Kayser
Community Outreach Specialist



skayser@corradino.com



(772) 579-5479

Ken Kroll
Construction Project Administrator



kkroll@cegroupfl.com



(786) 877-3834

Michael Jacobs
Construction Project Manager



michael.jacobs@dot.state.fl.us



(772) 429-4930

FDOT Safety Message





Thank you for taking the time to learn about the SR 70/Okeechobee Road Resurfacing construction project. We hope this informational video has provided you a clear understanding of the project and its benefits to the community.